

\$680,900 - 28 Beto Ln, Lewes

MLS® #DESU2100514

\$680,900

3 Bedroom, 2.50 Bathroom,
Residential on 2.23 Acres

NONE AVAILABLE, Lewes, DE

This is a to be built home.

Major Price adjustment!!!

LOCATION LOCATION LOCATION & SIZE,
MATTERS.

Enjoy the timeless charm of a to-be-built custom home by Bay to Beach Builders, renowned for their Amish craftsmanship and exceptional attention to detail. The Dogwood is a beautifully designed home that blends classic charm with modern functionality, offering 2,111 heated square feet of thoughtfully crafted living space. With 3 to 4 bedrooms and 2.5 bathrooms, this home provides ample space for those looking for a forever home. Designed for both beauty and practicality, the Dogwood is an excellent choice for those seeking a home that offers timeless appeal, and the flexibility to grow with their needs. One of the largest and most beautiful residential lots in Lewes, this 2.23-acre property offers rare space, privacy, and the perfect setting to build your dream home near the coast. Located within the secluded community of Beebe Farm, these opportunities rarely come available and are unheard of this close to the beach. Choose The Dogwood as shown or explore a variety of models and custom options to create the perfect home for your lifestyle. Concept home pending final approvals.

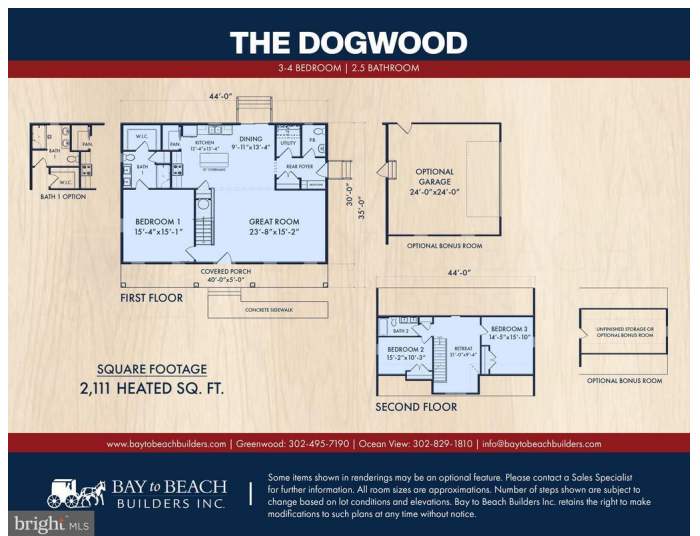

Zoned AR-1 and approved for a Low-Pressure Pipe (LPP) septic system. Its flat, secluded setting provides flexibility for design while still being close to town.

The property's size and privacy make it stand out compared to typical lots in the area. This land is ideal for a spacious single-family home with room for extras. Whether you envision a private retreat, a family estate, or a long-term investment, the possibilities are wide open. Located in Lewes, DE, you'll be minutes from Cape Henlopen State Park, with miles of beaches, trails, and nature. You are also just minutes from everything that Rt 1 has to offer, shopping, movies, dining, golf and entertainment. All close to the action without the inconvenience and noise of the traffic.

This listing can also be found as a lot only listing. MLS # DESU2097866

Downtown Lewes offers waterfront dining and boutique shopping. Rehoboth Beach is just a short drive away, while larger cities like Dover and Wilmington are within reach, giving you both small-town charm and easy access to amenities. Washington DC, Baltimore, Philadelphia and even New York, are all within an easy 2 to 3.5 hour drive.

Essential Information

MLS® #	DESU2100514
Price	\$680,900
Bedrooms	3
Bathrooms	2.50
Full Baths	2
Half Baths	1
Acres	2.23
Type	Residential
Sub-Type	Detached

Style	Other
Status	Active

Community Information

Address	28 Beto Ln
Area	Indian River Hundred (31008)
Subdivision	NONE AVAILABLE
City	Lewes
County	SUSSEX-DE
State	DE
Zip Code	19958

Amenities

Utilities	None
View	Garden/Lawn, Trees/Woods

Interior

Heating	Other
Cooling	Other
# of Stories	2
Stories	2 Story

Exterior

Lot Description	Backs to Trees, Partly Wooded
Foundation	Other

School Information

District	CAPE HENLOPEN
----------	---------------

Additional Information

Date Listed	November 12th, 2025
Days on Market	5
Zoning	AR-1

Listing Details

Listing Office	EXP Realty, LLC
----------------	-----------------



© 2025 BRIGHT, All Rights Reserved. Information deemed reliable but not guaranteed. The data relating to real estate for sale on this website appears in part through the BRIGHT Internet Data Exchange program, a voluntary cooperative exchange of property listing data between licensed real estate brokerage firms in which Northrop Realty participates, and is provided by BRIGHT through a

licensing agreement. Real estate listings held by brokerage firms other than Northrop Realty . are marked with the IDX logo and detailed information about each listing includes the name of the listing broker. The information provided by this website is for the personal, non-commercial use of consumers and may not be used for any purpose other than to identify prospective properties consumers may be interested in purchasing. Some properties which appear for sale on this website may no longer be available because they are under contract, have Closed or are no longer being offered for sale. Some real estate firms do not participate in IDX and their listings do not appear on this website. Some properties listed with participating firms do not appear on this website at the request of the seller.

Listing information last updated on November 16th, 2025 at 7:16am EST